

# INSTALLATION AND OPERATION MANUAL OF TAB TENSION ELECTRIC PROJECTION SCREEN



(Suitable for aluminum alloy shell)

Standard configuration:	Accessories:
1.HD screen 2.Synchronous motor Or tubular motor 3.Aluminum alloy case 4. Black bottom bar (Other colors can be customized)	Wall Pendant * 2 Power cord * 1 Screw * 4 Hook * 4 Expansion pipe * 4 Standard conversion plug * 1 Remote control handle * 1 Lifting ring * 2 Nut * 2

## Important safety instruction

Please strictly comply with the following safety rules, wrong installation or using methods will bring damage to machinery or personnel injury.

### Considerations for installing / using this product

1. Please handle with care.
2. Don't expose it in the rain and keep away from water.
3. Keep away from fire/heat.
4. Please don't fold or scratch the screen.
5. Check that the voltage is consistent with the requirement to use voltage, it can only connect the power plug and socket with grounding wire.
6. Don't scathing the screen fabric.
7. Please recover the screen after used.
8. Do not lift the screen continuously for a short time.
9. Ensure the screen to be installed in a horizontal position.



- Please pay attention to insulation of product Shell and accessories.
- Do not remove the end cap, to avoid risk of electric shock.



- Please follow the manual to operate.
- Please contact professional services staff for installation and maintenance.

**For any installation or operation error, we do not assume compensation liability for any mechanical damage or casualties.**

**Forbidden arbitrarily debug the screen.**

**It must be debugged under the guidance of professionals.**

### Cleaning:

Please carefully clean the screen fabric and shell with a dry soft cloth without corrosive ingredients and neutral soapy water. Do not use chemicals or corrosive materials, otherwise the product will be damaged.

# Installation

## Installation methods

## Wall mounting installation

Warning! ▲

- When installing the screen on the wall, please make sure the mounting points are on the same horizontal plane.
- When the screen expanded, it must keep parallel to the wall.

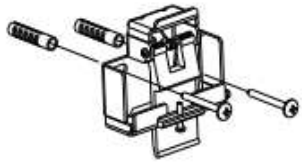

1



2

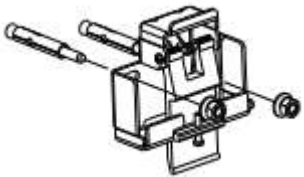

3



4

- 1-Wooden wall installation mode
- 2-Wooden ceiling top mounting installation mode
- 3-Concrete/brick wall installation mode
- 4-Concrete mounting installation mode

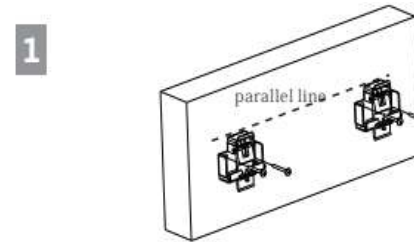

1

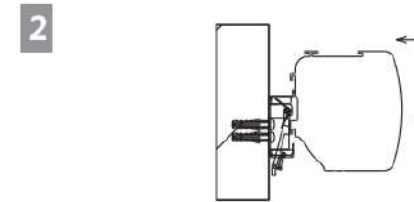

2

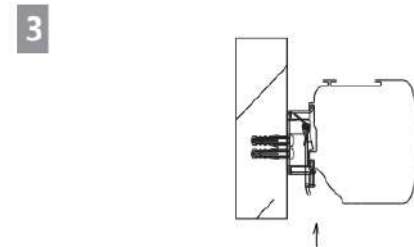

3

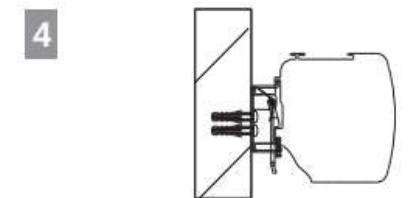

4

## ☑ Ceiling top mounting installation

Warning! ▲

While installing ceiling top mounting screen, the ceiling must have enough bearing capacity, in order to avoid the screen from falling off, and then lead to accidents and injuries.

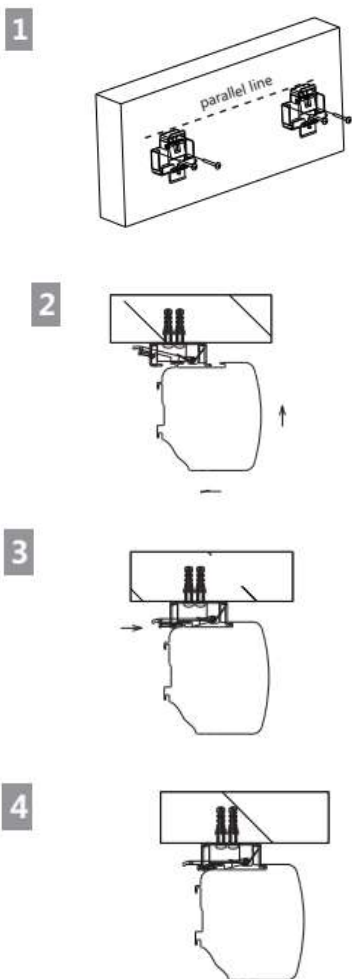

## ☑ Ceiling hanging installation

Warning! ▲

While installing ceiling top mounting screen, the ceiling must have enough bearing capacity, in order to avoid the screen from falling off, and then lead to accidents and injuries.

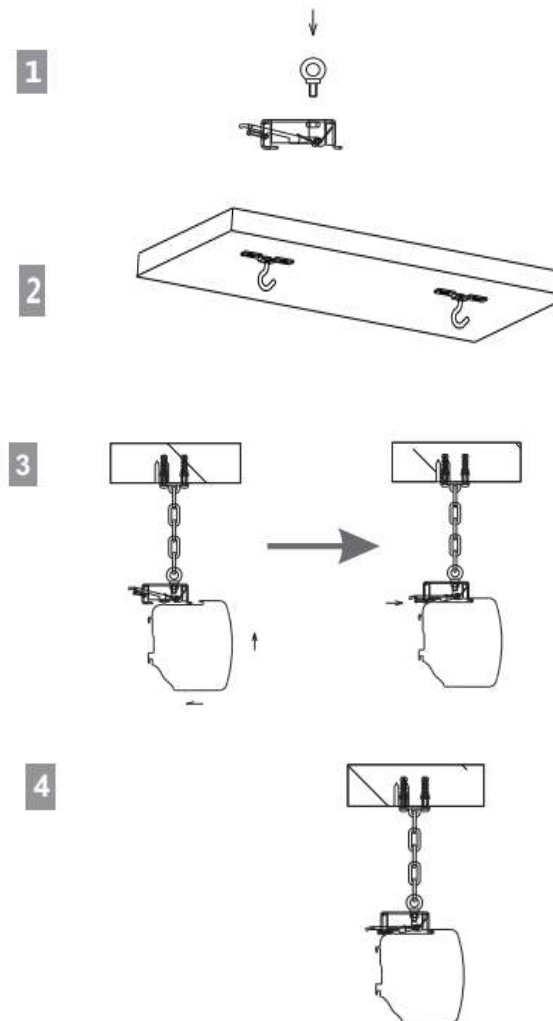

## Zenith Angle installation mode

Warning! ▲

While installing ceiling top mounting screen, the ceiling must have enough bearing capacity, in order to avoid the screen from falling off, and then lead to accidents and injuries.

1



2

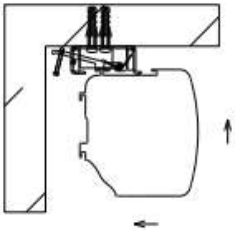

3

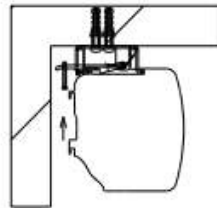

4

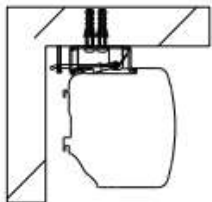

## USE

## Electric tab tension screen using method

There are two electric screen control modes, manual control mode and remote control mode.

### First: Manual control instruction:

Use the manual switch (see enclosure end cover control panel) to control the up and down pressing of the screen. "Green" button down, the screen will expand; The "red" button is down and the screen will retract.



Second: Wireless control is optional for users.

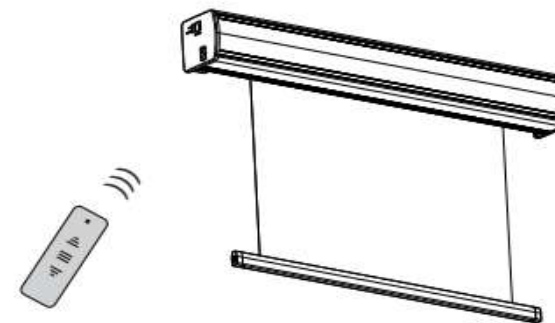

- 1. Down:** when this button is pressed, the screen will drop to the set position.
- 2. Up:** when this button is pressed, the screen will retract.
- 3. Stop:** press this button and the screen will stop.

## End cap control

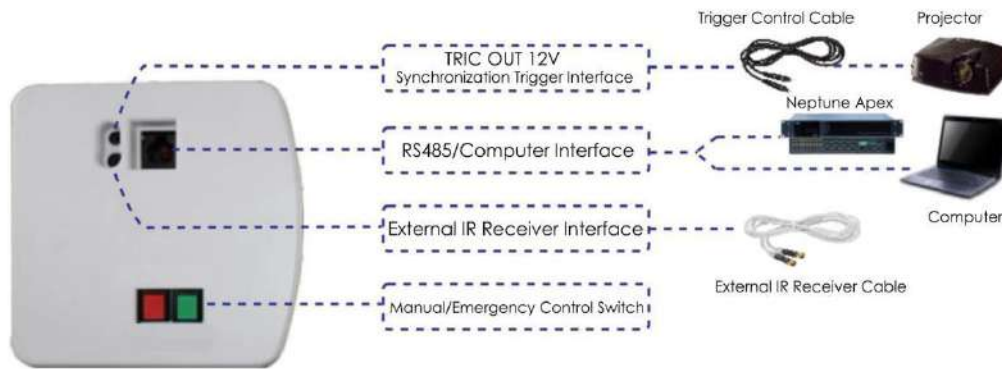

## External DC/AC 12V power control

- A、 When DC / AC 12V is powered on, the motor drops automatically
- B、 When the DC / AC 12V power supply is turned off, the motor rises automatically
- C、 Input voltage range: DC/AC 5V —— DC/AC 20V

## Screen stoke regulation

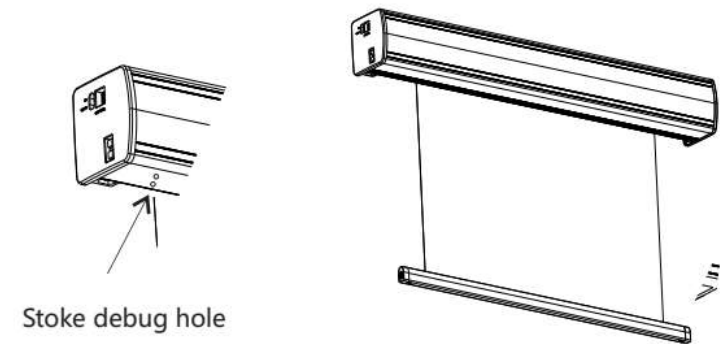

**Forbidden to arbitrarily debug the screen stoke, which should be debugged under the guidance of professionals.**

### Synchronous motor limit adjustment indication:

#### (Upward stroke) yellow hole:

Clockwise rotation to shorten the stroke,  
Counterclockwise rotation to upward the screen.

#### (Downward stroke) gray hole:

Clockwise rotation to shorten the stroke,  
Counterclockwise rotation to downward the screen.

### Tubular motor limit adjustment indication:

#### (Upward stroke):

Clockwise rotation to upward the screen,  
Counterclockwise rotation to shorten the stroke.

#### (Downward stroke):

Clockwise rotation to downward the screen,  
Counterclockwise rotation to shorten the stroke.