

三、如带中控遥控器中控调试（485接线方式：1脚为正，5脚为负）
For central debugging with the central controller (485 wiring: Pin 1 is positive, Pin 5 is negative)

中控调试：

Central Debugging:

本产品采用RS485的通讯模式，协议如下：
This product uses the RS485 communication mode, and the protocol is as follows:

串口数据代码结构说明：

Explanation of the Serial Port Data Code Structure:

串口命令：波特率 9600

Serial Port Command: Baud rate 9600

校验位： NONE

Data bit: NONE

数据位： 8

Data bits: 8

停止位： 1

Stop bit: 1

16进制地址码

Hexadecimal address code

串口群控制：

Serial port central controller:

01 FE 00 01 FE 00 01 FE 00 01 FE 00 (上) (UP)

02 FE 00 02 FE 00 02 FE 00 02 FE 00 (下) (DOWN)

03 FE 00 03 FE 00 03 FE 00 03 FE 00 (停) (STOP)

FE为公共地址 (Common ground)。

串口分控制：

Serial port single controller:

修改地址码：

Modify address code:

00 XX 00 00 XX 00 00 XX 00 00 XX 00

01 XX 00 01 XX 00 01 XX 00 01 XX 00

02 XX 00 02 XX 00 02 XX 00 02 XX 00

03 XX 00 03 XX 00 03 XX 00 03 XX 00

XX单片机地址，默认为00。

XX Singlechip computer address code defaults 00.

电动吊架（电子限位）使用说明书

Operation Manual for Electric Hanger (Electronic Limit)

一、零部件 COMPONENTS

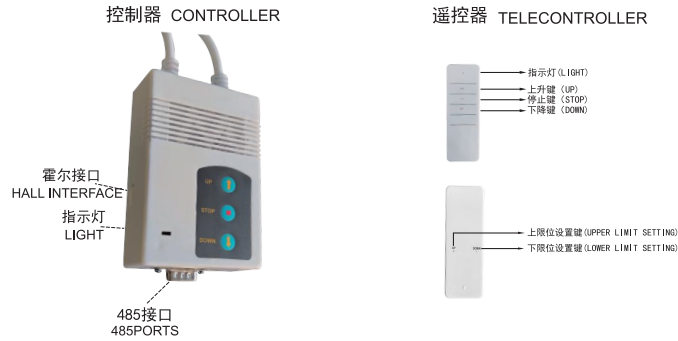

注意：使用霍尔控制时必须把霍尔线插上，否则执行时间限位控制。

ATTENTION: When using the Hall controller, the Hall wire must be connected; otherwise, the system will operate based on time limit control.

二、遥控器操作 Remote Control Operation

注意：1. 控制器与遥控器对码需在8秒钟内完成，延时退出需重新对码。

2. 在多个电动吊架场所需重新对码，不能同时切断多个电动吊架控制器电源，只能切断需对码的那个电动吊架控制器的电源并再打开电源进行对码。

3. 出厂时遥控器已对码，无需重新对码。

Attentions:

- The controller and remote control must complete code matching within 8 seconds. If the time runs out, the code must be matched again.
- When multiple electric hangers are in use, code matching must be performed separately. Do not cut off the power supply of multiple electric hanger controllers at the same time. Only turn off the power of the controller that needs to be matched, then turn it back on for code matching.
- The remote control is pre-matched at the factory, so no additional code matching is required.

1、控制器与发射器对码（配对）

Controller and transmitter code matching (Pairing)

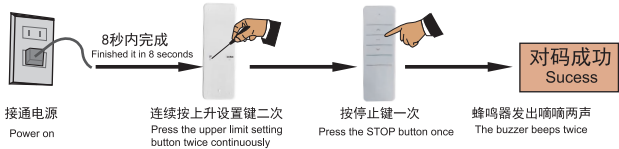

2、上限位置设置

Upper limit position setting

提示：安装后必须调整上限位和下限位，上限位和下限位可以单独设置
NOTE: After installation, the upper and lower limit positions must be adjusted. They can be set separately.

