

III. Bezel frame assembly

- a. Lay the screen directly on the front side, take the bezel frame one by one into the corresponding inner frame; adjust the position of the bezel frame, refer to the inner frame 45° trimming surface alignment.
- b. Slide the pre-assembled sliding nut to the two ends, hook the hook end of the thin bezel frame brackets to the outermost slot of the decorative frame, and align the long round hole at the other end with the sliding nut. Twist the M5X6mm corner screws gently.
- c. Adjust the position of the four bezel frames to minimize the gap of the 45° cutting edge of the four corners, lock the screws, and complete the screen assembly. It is recommended that the thin bezel frame brackets be installed in the first four corners and then the middle.

III/a

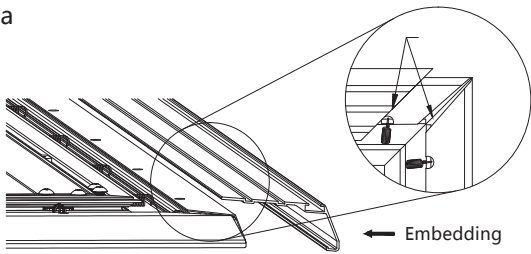

III/c

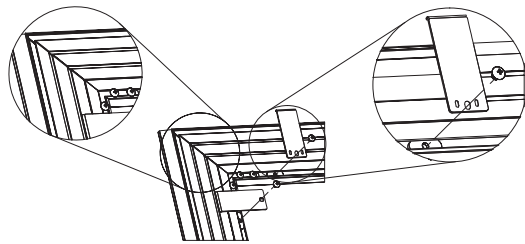

- d. Note: When gap of the 45° cutting edge of the four corners is too large and the two bezel frames cannot be pressed together tightly, a slender steel bar can be used to extend into the pry hole and prize the thin bezel frame brackets for tightening.

III/d

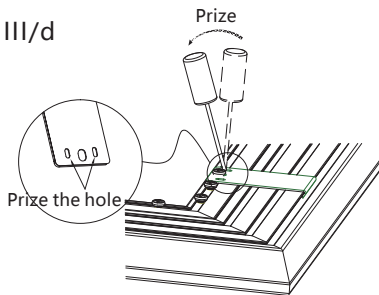

IV. Screen fixing method

- a. Slide the remaining sliding nut on the inner frame above the screen so that it is symmetrically distributed at the 2/3 position of the total length of the screen. Use the M5*8mm screws to lock the hanging plate. At the bottom frame, at the vertically same position, use the M5*8mm magnet mounting screw is to lock the attached disc.
- b. Use a suitable tool to horizontally install the concrete anchors at a suitable upper position on the wall. The horizontal spacing A is equal to the pitch of the hanging plate. Screw in a 5x50 Phillips head screw so that the screw head surface is about 5-7 mm away from the wall. In the corresponding lower position, the magnetic is installed vertically, and the spacing B is equal to the total height of the screen minus 117mm.
- c. Need two persons cooperated to lift the screen, and the top was slightly inclined. The mounting brackets holes were aligned with the raised Phillips head screws. After hanging firmly, slightly place the screen, and the magnetic force of the magnetic sucked the attached discs to complete fixed of the screen. (Be sure to check if the screen is secure. If necessary, adjust the position of the attached disc to make it aligned.)

IV/a-b

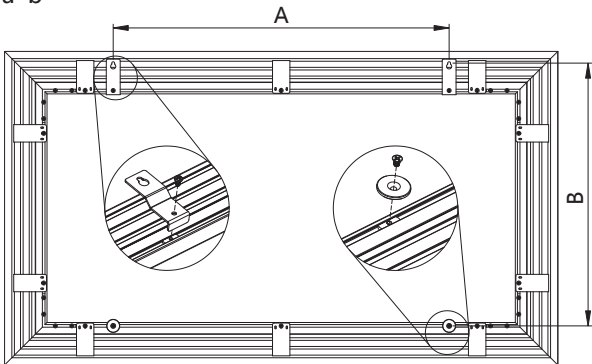

IV/c

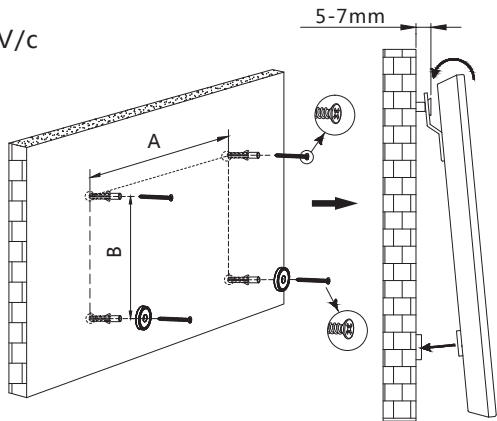

Maintenance screen

In order to ensure that you have a good screen quality for a long time, please use a curtain to cover the screen when you are not using it for a long time to prevent dust and dirt from contaminating the screen.

Clean the screen

Clean the screen with warm water or a soft soapy water to clean it. Remember that the cleaning method cannot tear the screen hard to avoid permanent deformation. Do not use diluents, organic solvents, or corrosive detergents.

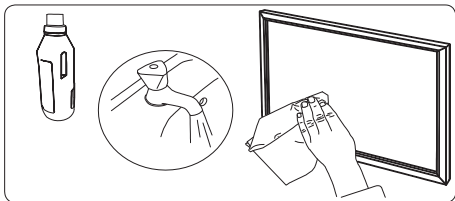

Liberty Grandview

Instruction Manual for
Flash Series Fixed Thin Frame Screen

Model: PF-Lxxx(S1)

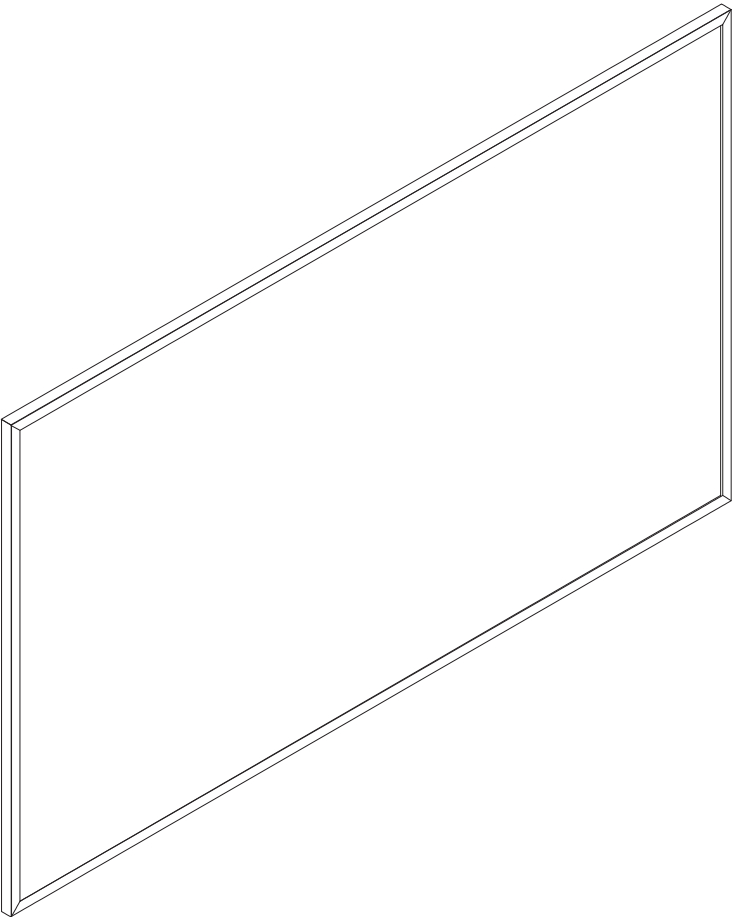

Kind Reminder

- Thank you for purchasing a Grandview projection screen. Before use, please read instructions carefully. After installation, store instructions for future reference.
- Please proceed installation on flat and clean ground to provide protection for the screen fabric and maintain the perfect frame assembling.
- Please be careful about the sharp edges while installing to avoid cutting.

AV-VISION
EQUIPMENTS (INDIA) (P) LTD.

Mktg. Off: 1-20-248, 2nd Floor, (Snowcem Paints Lane),
Rasoolpura, Secunderabad-500 003, A.P., INDIA,
Tel : +91(0)40-2781 5419 / 2781 4350 / 2789 0599 / 2781 8419 / 20 / 21
Fax : +91(0)40-2781 5399 (Off.) / 2781 4612 (Mktg)
Mobile: + 91- (0) 99590 24099 / 98490 24099
E-mail : sales@av-visionindia.com
Website : www.av-visionindia.com

Grandview Crystal Screen Canada Ltd.

#11- 3751 North Fraser Way,
Marine Way Business Centre,
Burnaby, BC, Canada V5J 5G4
Tel: 1-604-412-9777 Fax: 1-604-412-9796
Website: www.grandviews

Guangzhou Grandview Crystal Screen Co., Ltd.

P.O. 511400 Federal Ind. Zone No. 363, Yushan West Road,
Shiqiao, Panyu District, Guangzhou, Guangdong, China
Tel: +8620-8489-9499 Fax: +8620-8480-3343
Website: www.grandviewscreen.com
www.grandviewscreen.com.cn

Screen structure

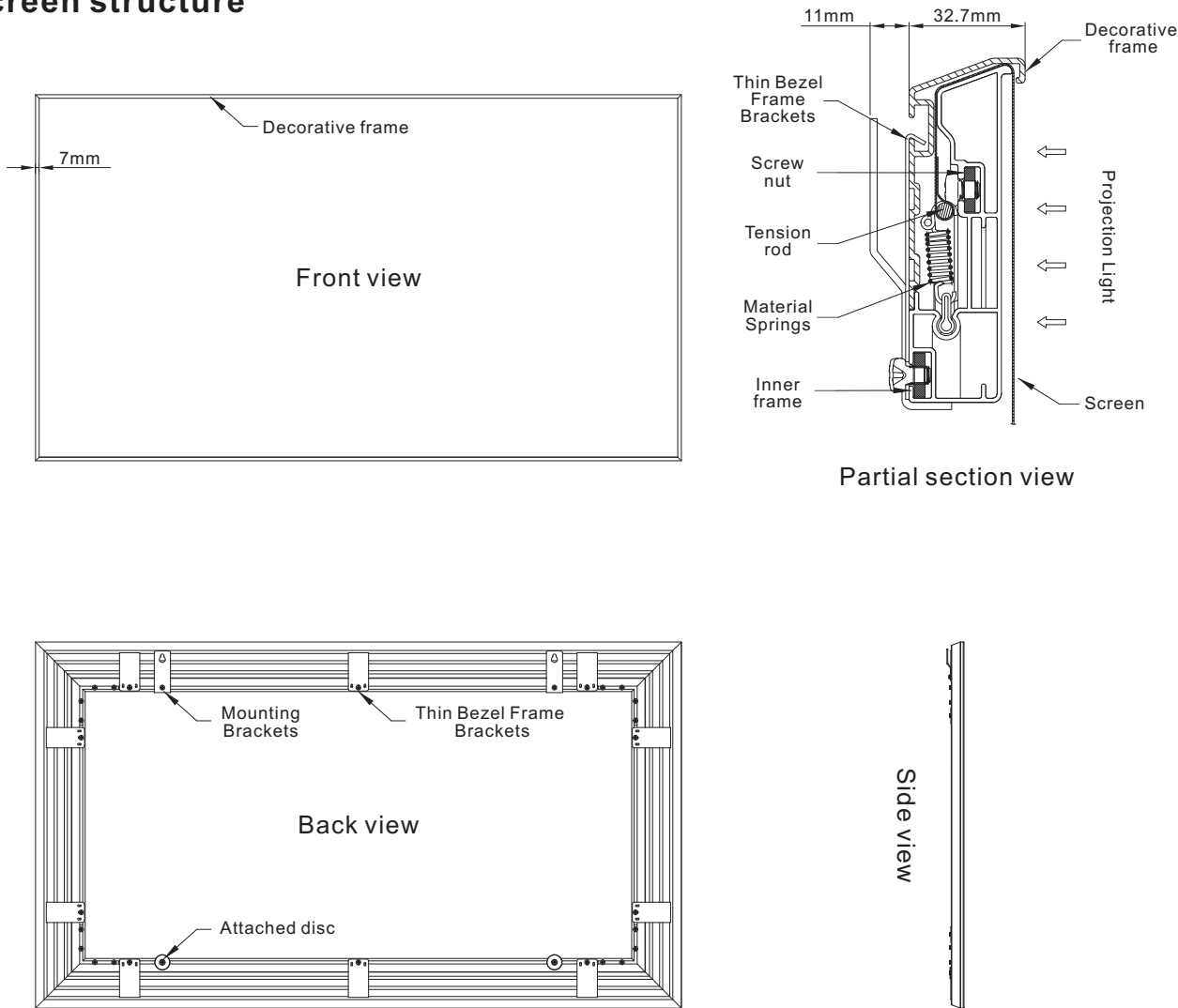

Screen component

Please check whether the screen components are complete before assembly; some screws and accessories are available in order to replace them after damage during installation.

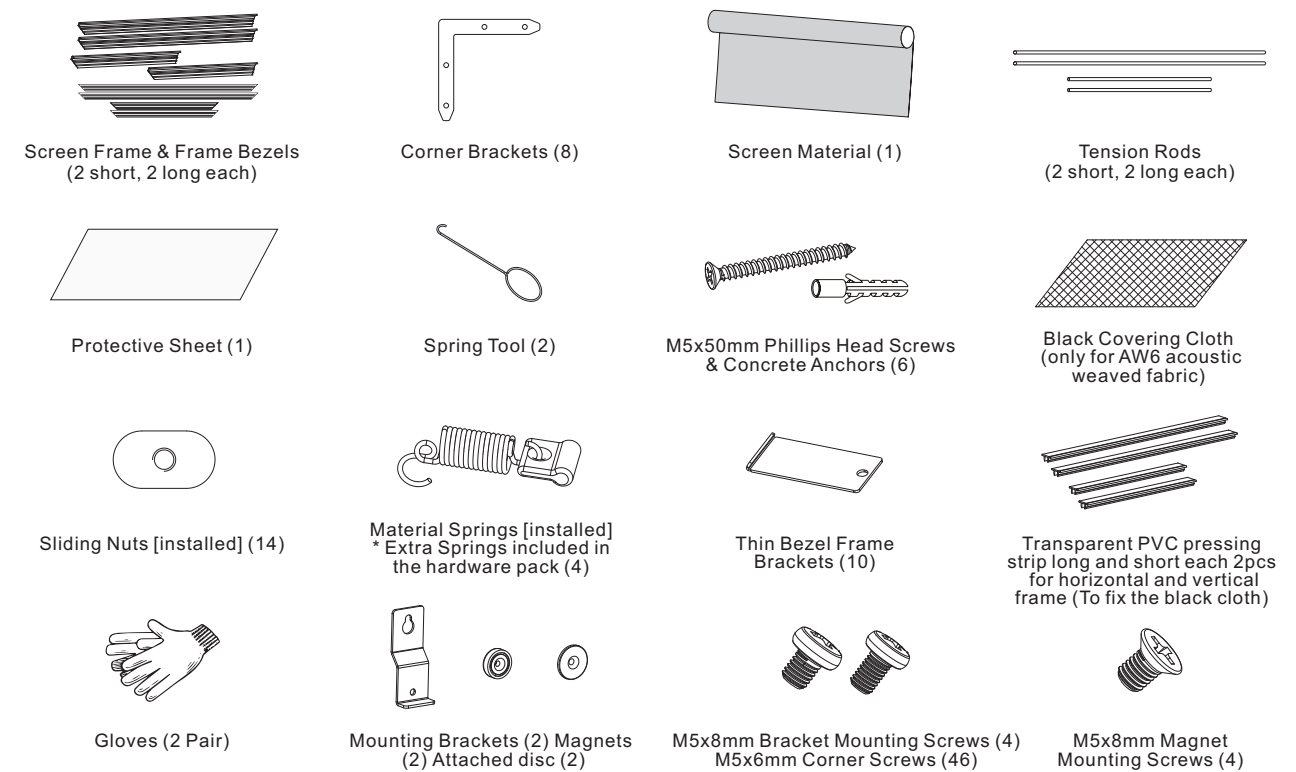

Screen assembly method

I. Inner frame connection method

a. Gloves should be worn before installation. After cleaning the site, the pearl cotton film is distributed on the bottom pad. Four long and short inner frames are placed into a rectangle.

b. Check that the number of tension spring assemblies and sliding nuts pre-assembled in the inner frame is correct. The number of sliding nuts is 5 for each long frame and 2 for each short frame. The number of conventional size tension spring assemblies is shown in the table below. If it is found to be missing, please make up enough.

Qty. of Pre-assembly Springs					
Screen size (16:9/16:10)	92"	100"	106"	110"	120"
Each long sides	12	12	14	14	14
Each shot sides	7	7	8	8	9

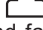

c. The Corner Brackets are respectively inserted into the upper and lower  shaped grooves of the four right-angled inner frames, and fasten by the M5X6mm corner screw one by one angle is 90°.

d. Adjust the border to full alignment and tighten the screws to complete the inner frame connection. This step will affect the appearance of the bezel frame, please be patient for perfect matching.

II. Black covering cloth installation

If you are purchasing this product with AW6 acoustic weaved fabric, before you install the projection fabric, please install the black cloth first to block the reflection of the projection light onto the frame metal surface. Detail as below:

a. Lay the fabric flat, then put the installed screen frame onto the black cloth center.

b. Fold up the black cloth from four sides and use the  shape PVC pressing strip (the L shape locking leg outward as in II/a -c) to press down the black cloth into the  shape frame notch for stabilization.

c. Adjust the black cloth until it fits.

III. Screen installation

a. The tension rods side's up and tiled on the screen (note that the site is cleaned, and there is no raised object on the bottom). The front side of the frame is placed on the screen with the front side facing down, and the long and short tension rods are respectively inserted into the corresponding curling holes inside, ensure that the exposed ends of the tension rods are all equal in length.

b. Adjust the relative position of the frame and the screen to make it centered symmetrically for easier installation. Note: The inner frame edge is sharp, so be careful when moving to prevent cutting your hand or cutting the screen.

c. Use the spring tool to hook the small round hole on the tension spring, and drag all the tension spring assemblies to the corresponding screen holes to prepare the installation screen.

d. Fold the screen edge, pull the tension spring with the spring tool, and hang the tension rods in the hole of the screen; it is recommended to hang the 2-3 tension springs in the middle of the four sides, adjust the position of the screen to center, then hang the position of the four corners, and finally hang up all the remaining springs .

e. If wrinkles, waves are present, the reason is that the screen is not completely tight, you can gently adjust it from the middle to the outside until the four corners of the screen completely cover the border.

Precautions:

1. When you purchase a PVC elastic soft screen, because the material of the screen is shrinkable, the size of the screen will be reduced after a long time, and it can be appropriately elongated during installation.

2. If the force is too large when hanging the spring, it will cause permanent deformation. If the tension spring fails, please replace it in time.

I/a-c

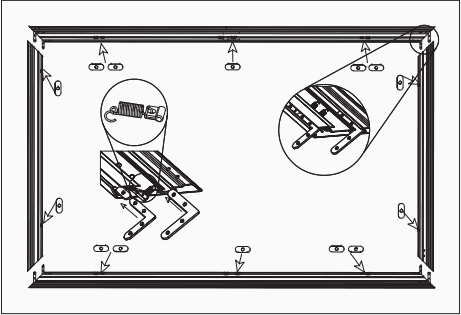

I/d

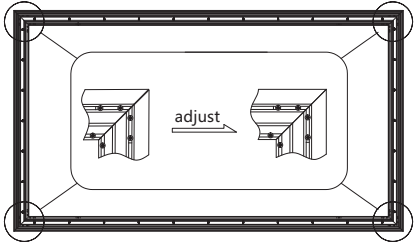

II/a-c

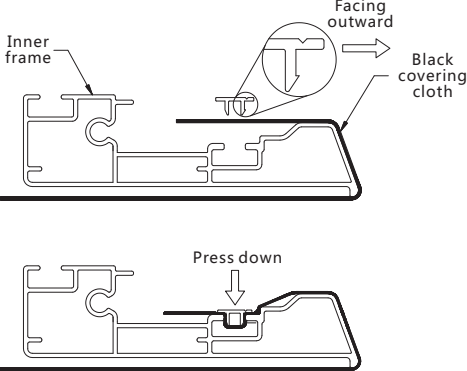

III/a-b

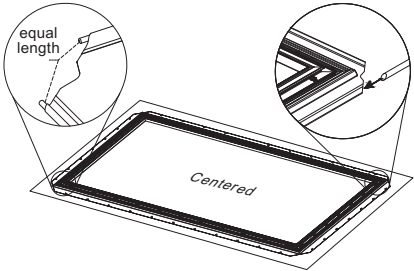

III/c-d

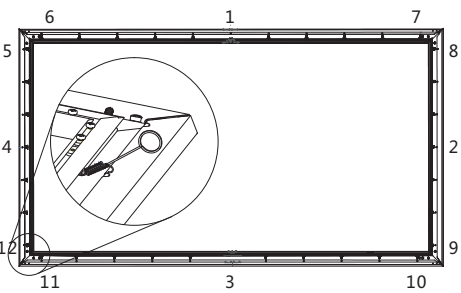

III/e

